

FANS - MOTORS - GEARS & PULLEYS

DC MOTORS

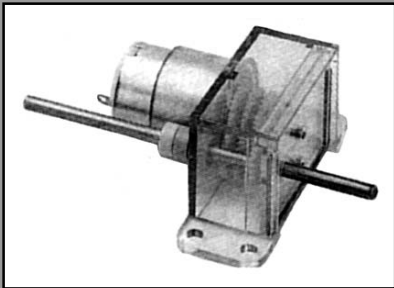

MOTOR WITH GEARBOX



PULLEYS



GEARS



COOLING FANS



CAMS	390
CHAIN & SPROCKETS	391
COOLING FANS	392
DC MOTORS	386 - 387
FAN GUARDS	392
FRICTION MOTOR	389
GEARS	390
MINIATURE GEARBOX	391
MODULE 1 GEARS	390
MOTOR AND GEARBOXES	387 - 389
PERFORATED STEEL SHEET	391
PROPELLERS	391
PULLEYS	389 - 390
SOLAR MOTORS	387
UNIVERSAL JOINT	391
WATER PUMP	389
WHEELS	391

CONTENTS

SQUIRES MODEL & CRAFT TOOLS

DC MOTORS

MINIATURE DC MOTOR a miniature 1.5 to 4.5V DC motor ideal for modelling and robotics etc, suitable for mounting to PCB's etc. Solder tag terminations. Bi-directional rotation.

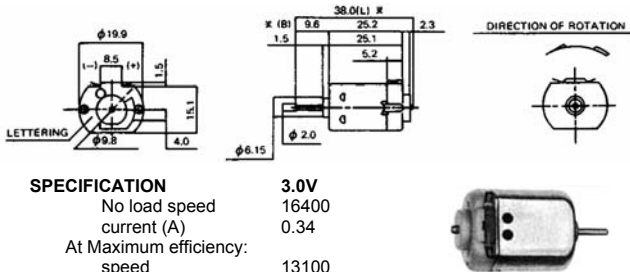

SPECIFICATION	3.0V
No load speed	16400
current (A)	0.34
At Maximum efficiency:	
speed	13100
current (A)	1.07
torque (g/cm)	8.0
Weight	17g



CODE	TYPE	PRICE
570-219	Miniature DC Motor 1.5-4.5V.....	£0.90

MEDIUM TORQUE MINIATURE DC MOTOR a miniature motor offering a higher stall torque than the above type. Operating voltage 1.5 to 4.5V DC. Solder tag termination. Bi-directional rotation.

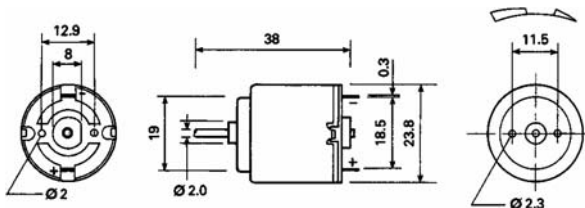

SPECIFICATION	1.5V	3.0V
No load speed	3000	6700
current (A)	0.083	0.45
At Maximum efficiency:		
speed	2300	5240
current (A)	0.26	0.45
torque (g/cm)	5.2	10
Weight	28g	



CODE	TYPE	PRICE
570-220	Medium Torque DC Motor 1.5-4.5V.....	£0.99

3V, 12,200 RPM MINIATURE MOTOR a 3V miniature motor ideal for low voltage applications using, for example, two 1.5V batteries. Applications include motorised toys, models, etc. Connection is by means of 2.8mm fast-on connectors, or by soldering. Stall current 1.17A.

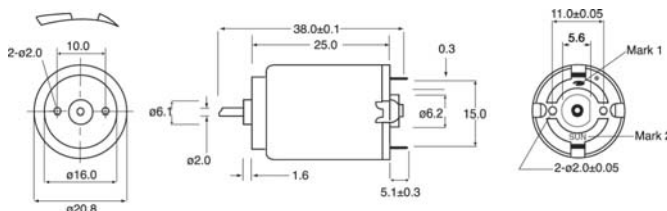

NOMINAL Constant Volts	NO LOAD		AT MAXIMUM EFFICIENCY					Eff. %	Stall Torque g-cm
	Speed rpm	Current A	Speed rpm	Current A	Torque g-cm	Output W			
3.0V	15000	0.340	12200	0.832	10.4	1.145	45.86	26.7	



CODE	TYPE	PRICE
570-224	3V Miniature Motor.....	£0.99

MINIATURE MOTOR 3V 8,000 RPM a high torque miniature DC motor for higher power requirements. Operating voltage 1.5 to 6.0V DC. Rotates clockwise when viewed from shaft end. Solder tag termination.



Technical Specification

Rated voltage	3V DC
No load current	0.23A max
No load speed	9,000rpm ±15%
Rated load	10.0 g.cm
Rated load current	0.63A max
Rated load speed	8,000rpm ±12%
Length excluding shaft	30.5mm
Diameter	24.2mm
Shaft length	12mm
Shaft diameter	2mm
Weight	42g approx

CODE	TYPE	PRICE
570-222	Miniature Motor 3V 8,000rpm.....	£1.25

12V MOTOR DOUBLE SHAFT a miniature 12V motor which has the same dimensions as the 570-222 motor but has a double ended shaft. Voltage range 6 - 12Vdc/45mA. No load speed 8,000 rpm.



CODE	TYPE	PRICE
DCM610	12V Motor Double Shaft.....	£4.50

SELF ADHESIVE MOTOR MOUNT a push fit motor mount with a self adhesive pad. Suitable for use with our miniature DC motors - DCM010, DCM020, DCM030, 570-105, DCM600, DCM610 and miniature motors of similar size. Length 25mm. Supplied individually and in packs of 10.



CODE	TYPE	PRICE
DCMM60	Self Adhesive Motor Mount.....	£0.70
DCMM61	Self Adhesive Motor Mount Pack of 10.....	£6.30

12V MOTOR MM36 a 5 pole 12V high torque motor suitable for various applications including modelling and robotics requiring a smooth, reliable performance. Fits mounting bracket BRK385.

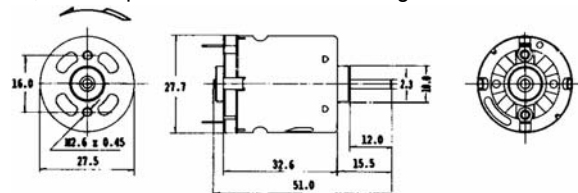

NOMINAL Constant Volts	NO LOAD		AT MAXIMUM EFFICIENCY					Eff. %	Stall Torque g-cm
	Speed rpm	Current A	Speed rpm	Current A	Torque g-cm	Output W			
12.0V	13500	0.200	10700	0.768	41.3	4.54	49.2	200	

CODE	TYPE	PRICE
570-050	12V Motor MM36.....	£3.99

MABUCHI 385 12V MOTOR a high quality 5 pole 12V Mabuchi 385 motor. Operating voltage range 6 - 18Vdc. No load speed @ 12V 12,000 rpm. No load drain 0.25A. Diameter 28mm, length overall 57mm.



CODE	TYPE	PRICE
570-385	Mabuchi 385 12V Motor.....	£3.99

SQUIRES MODEL & CRAFT TOOLS

MOTOR MM-543M a 3 pole motor designed for heavy duty applications where high power is required, ideal for modelling, robotics and industrial applications, proto-typing etc.

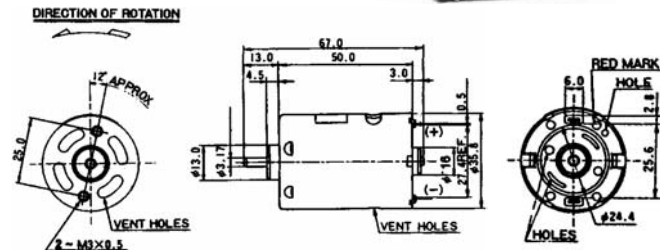

NOMINAL Constant Volts	NO LOAD		AT MAXIMUM EFFICIENCY					Stall Torque g-cm
	Speed rpm	Current A	Speed rpm	Current A	Torque g-cm	Output W	Eff. %	
6.0V	8900	0.70	7540	3.32	174.4	13.48	67.63	980
12.0V	16200	1.50	14070	4.63	236.5	34.13	61.45	1800

CODE	TYPE	PRICE
570-540	MM543M Motor 6-12V.....	£4.50
BRK540	Bracket for 540/545 Motors.....	£2.90

MOTOR MM-545Y a high quality 5 pole motor for heavy duty applications where high power and smooth running is required. Ideal for modelling, robotics and industrial applications, proto-typing etc.

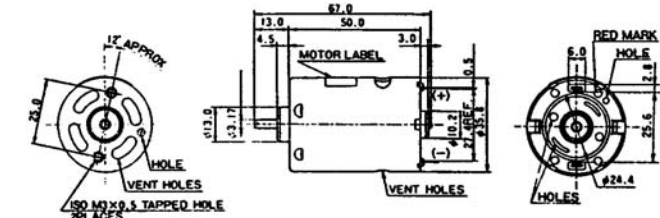

NOMINAL Constant Volts	NO LOAD		AT MAXIMUM EFFICIENCY					Stall Torque g-cm
	Speed rpm	Current A	Speed rpm	Current A	Torque g-cm	Output W	Eff. %	
7.2V	20100	1.95	17400	6.9	208	28.5	66.0	1250

CODE	TYPE	PRICE
570-545	MM545Y Motor 6-12V.....	£4.99
BRK540	Bracket for 540/545 Motors.....	£2.90

MOTOR BRACKETS motor brackets suitable for use with 380/385 or 540-545 pattern motors. Supplied with screws for fixing the motor to the bracket. Four fixing holes for mounting bracket to base. Base dimensions:-
380/385 pattern:- 45 x 40mm.
540/545 pattern:- 55 x 52mm.



CODE	TYPE	PRICE
BRK385	Bracket for Mabuchi 380/385 Motor.....	£2.75
BRK540	Bracket for 540/545 Motors.....	£2.90

SOLAR MOTORS

SOLAR MOTOR a high quality low-inertia type motor, suitable for low-power applications including solar cells and modules. Starting current just 10mA. Voltage range 0.7 to 5.0V. Dimensions 25mm (dia) x 12mm (L) with a 2mm diameter shaft.



Technical specification

Nominal Constant Volts	No Load		At maximum efficiency				Stall Torque g-cm
	Speed rpm	Current A	Speed rpm	Current A	Torque g-cm	Output W	
2.0V	2200	0.018	1540	0.055	2.8	0.05	11

CODE	TYPE	PRICE
570-453	Solar Motor.....	£3.75

SOLAR MOTOR DRIVE a miniature gearbox and solar motor which provides a gear ratio of 27:1 providing approximately 25rpm at 0.5 volts. Final gearbox output is via a 2mm shaft enabling the construction of many solar powered projects. Motor operating range 1.5 to 4.5V. Gearbox dimensions 36 x 15mm.



(Requires assembly.)

CODE	TYPE	PRICE
570-454	Solar Motor Drive (Requires Assembly).....	£7.99

MOTOR AND GEARBOXES

MOTOR & GEARBOX 40:1 1.5 - 6V DC a high quality gearbox fitted with a 6V motor. The motor will operate from 1.5V to 6V. The motor speed is 6,000rpm @ 6V, gearbox reduction 40:1. Output shaft diameter 4mm.



CODE	TYPE	PRICE
570-130	Motor & Gearbox 40:1 1½ - 6Vdc.....	£4.99

WORM DRIVE GEARBOX WITH MOTOR a robust worm-drive gearbox powered by an MM28 motor (included). Suitable for applications where an easy to fit, high torque output is required. Ideal for student projects including robots and buggies. 4 mounting holes in base.



Technical Specification

Motor operating voltage	3 to 6V DC
Motor speed	3V no load 9,700rpm 6V no load 17,100 rpm
Motor stall torque at	3V 122g-cm 6V 220g-cm
Gearbox ratio	42 to 1
Axle diameter	3mm
Axle length	125mm
Fixing holes	4 x 4mm
Overall dims of box + motor	W35 x H40 x L60mm

CODE	TYPE	PRICE
570-111	Motor & Gearbox 42:1 3 - 6Vdc.....	£4.99

4.5V MOTOR AND GEAR BOX UNIT these 4.5V DC motor and gearbox units are available in a choice of 1:762 or 1:1620 gearbox ratios. They have a 4.5V working voltage and a low no-load current.



Technical Specification

	12-0446	12-0447
Gear ratio	1:762	1:1620
Recommended voltage	4.5V DC	4.5V DC
Rotational direction	Bi-directional	Bi-directional
No-load speed	3.9 to 6.5rpm	2.1rpm ±0.1
No-load current	85mA	85mA
Output torque min.	1.7kgf.cm	3kgf.cm
Maximum efficiency current	0.28A	0.28A
Mechanical noise max.	45dBA	45dBA
Dimensions	45.9 x 27 x 35.45mm	45.9 x 27 x 35.4 x 41.75
Operating temperature range max.	+10°C to +60°C	+10°C to +60°C
Weight	43.5g	47.6g

CODE	TYPE	PRICE
12-0446	4.5V Motor & Gearbox 1:762 Ratio 3.9 - 6.5rpm.	£5.99
12-0447	4.5V Motor & Gearbox 1:1620 Ratio 2.1rpm.....	£5.99

SQUIRES MODEL & CRAFT TOOLS

ECONOMY INLINE MOTOR & GEARBOX 1:120 a smooth running motorised gearbox fitted with a 3 to 12V DC motor. The single output shaft is 5.5mm diameter and 9mm long with 2 flats. Gear ratios of 1:120 give final speeds of between 70 - 140rpm depending on voltage used. 3x mounting holes, ideal for small educational projects including fairgrounds and robots and other models. Dimensions L70 x W20 excluding shaft x W20mm.

Weight: 30g.

Specification

No load current:
70 - 130mA
Under load at 6.0V:
output turning power
1.8kgf.cm



CODE	TYPE	PRICE
12-1217	S/Output Inline Motor & G/Box 3 - 12Vdc 1:120...	£2.99

ECONOMY INLINE MOTOR & GEARBOX 1:200 a smooth running motorised gearbox fitted with a 3 to 12V DC motor. Available with a single or double output shaft. The output shaft is 7mm diameter and 5mm long with 2 flats. Gear ratios of 1:200 give final speeds of between 25 - 100rpm depending on voltage used. 3x mounting holes, ideal for small educational projects including fairgrounds and robots and other models. Dimensions L68 x W20 excluding shaft x W22mm. Weight: 30g.

Specification

No load current:
40-230mA
Under load at 6.0V:
output turning power
2-12Kgf.cm



CODE	TYPE	PRICE
12-1221	D/Output Inline Motor & G/Box 3 - 12Vdc 1:200...	£3.99
12-1214	S/Output Inline Motor & G/Box 3 - 12Vdc 1:200...	£3.99

ECONOMY RIGHT ANGLE MOTOR & GEARBOX 1:220 a low-cost miniature right-angled DC motor with many applications including models, robotics and educational demonstration equipment. The output shaft has 2 flat sides on the motor shaft, the motor is a bi-directional 3 - 12Vdc motor, the gearbox ratio 1:220 give final speeds of between 18 - 180rpm depending on voltage used.. Dimensions L68 x W20 excluding shaft x W22mm. Weight: 30g.

Specification

No load current:
70 - 130mA
Under load at 6.0V:
output turning power
1.8kgf.cm



CODE	TYPE	PRICE
12-1216	Right Angle Motor & Gearbox 3 - 12Vdc 1:220....	£3.99

2 IN 1 GEARBOX a gearbox kit which contains, electric motor (3 - 6V), 2 sets of gears giving either a 60:1 or 228:1 reduction (approx 200 or 42 rpm), gearbox chassis and shafts.



CODE	TYPE	PRICE
570-765	2 in 1 Gearbox Kit.....	£7.50

MULTIRATIO GEARBOX AND MOTOR a multiratio gearbox supplied in kit form which allows eight different transmissions from 5:1 to 1125:1 to be obtained. Included in the kit is a medium torque motor which will operate from 1.5V to 4.5V DC. The gearbox is easy to mount to any surface with the slots that are provided in the mounting plates. Output shaft is 3mm diameter. Ideally suited to many projects

in education, prototyping. Supplied with full instructions on assembly and gearbox ratios.



CODE	TYPE	PRICE
570-455	Multiratio Gearbox and Motor 1.5V - 4.5V.....	£7.50

MULTIRATIO GEARBOX AND MOTOR a multiratio gearbox supplied in kit form. The drive motor operates on 1.5, 3.0 or 4.5V DC power sources - batteries or a suitable transformer. Its simple versatile design and sturdy construction make it suitable for a host of applications including powering models and robots to teaching the principles of mechanics. Current consumption depends on load but is within the range 0.2 to 0.8A. Output shaft is 3mm diameter, Gearbox is mounted on flanged frame for easy mounting.

Technical Specification

Ratio	RPM		
	1.5V	3V	4.5V
4:1	966	1932	2898
16:1	241	483	724
64:1	60	121	181
256:1	15	30	45
1024:1	3	7	10
4096:1	1	2	3



CODE	TYPE	PRICE
570-110	Multiratio Gearbox and Motor.....	£9.99

MOTOR AND GEARBOX the "Clearbox Motor" has a polycarbonate gear casing and tough nylon gears with a 4mm diameter output shaft. The gearbox is driven by a miniature 1½ to 6V DC motor. At 6V, the motor has a free running speed of approximately 6,000 rpm. Speeds ranging from 2.6 to 625 rpm can be obtained by using the intermediate gears supplied. Suitable applications include modelling and robotics etc. Spare gear kits are available separately.

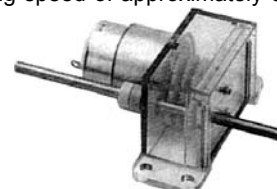

CODE	TYPE	PRICE
DCM060	Motor with Gearbox.....	£9.99
CBGS65	Spare Gears for Clearbox Motor.....	£3.99

TWIN MOTOR GEARBOX KIT a twin motor gearbox employing a two motor system to provide power and speed to turn the round shaft in two different directions. The gear box is made from high quality plastic. Ideal mechanical toys and robotic products. Two battery powered motors are included. The easily adjusted gearboxes can be used with a gear ratio of 1:60, 1:120 or 1:288. Ideal for hobbies and education projects. Two motor and gearbox sets to have wheels running in different directions, wheels, tyres and all other necessary parts included together with an easy to follow instruction manual.



CODE	TYPE	PRICE
12-1218	Twin Motor Gearbox Kit.....	£13.99

SQUIRES MODEL & CRAFT TOOLS

IGARASHI MOTOR & GEARBOX a range of high quality permanent magnet 12V DC motor and gearbox, ideal for modelling, robotics and proto-typing etc. Voltage range 6-15V DC. Motor speed:- 1700rpm @ 6V, 3800rpm @ 12V, no load drain 50mA @12V. The reduction gear box is fitted with metal gears, the shaft runs in bronze bearings. The motor will run in either direction.

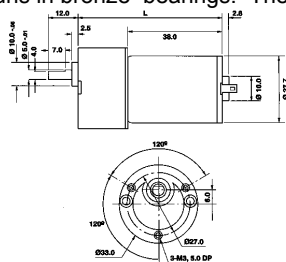

CODE	TYPE	Dimension L mm	PRICE
DCM250	12V Igarashi Motor & Gearbox 8:1	L = 57.....	£25.99
DCM251	12V Igarashi Motor & Gearbox 20:1	L = 57.....	£25.99
DCM252	12V Igarashi Motor & Gearbox 50:1	L = 57.....	£25.99
DCM253	12V Igarashi Motor & Gearbox 125:1	L = 62.....	£27.99
DCM254	12V Igarashi Motor & Gearbox 312:1	L = 62.....	£29.99
DCM255	12V Igarashi Motor & Gearbox 781:1	L = 67.....	£29.99
DCM256	12V Igarashi Motor & Gearbox 1953:1	L = 67.....	£29.99

FRICTION MOTOR

FRICTION MOTOR with double thickness flywheel and 2 gears. The housing has 3 fixing holes, the drive shaft is 4mm diameter, length 105mm.



CODE	TYPE	PRICE
570-187	Friction Motor.....	£3.50

WATER PUMP

BOHLER WATER PUMP a 12V DC water pump with a capacity of 8 litres per minute @ 0.6bar. The pump is sealed allowing the pump to be immersed fully into the water. A delivery hose is required, the pump outlet has an external diameter of 9.5mm with a step up to 10.75mm. Not suited to constant running, use for pumping **WATER ONLY**. Height overall including cable entry 100mm, diameter of pump body is 30mm.



CODE	TYPE	PRICE
570-091	Water Pump.....	£19.99

**POST FREE DELIVERY ON ALL ORDERS
WITHIN THE UNITED KINGDOM
MINIMUM ORDER VALUE £15.00**

**You may mix your order from
ANY of our catalogues**

PULLEYS

A wide range of miniature gears and pulleys suitable for use with the listed motors and similar types. The fixing bores are moulded smaller than the stated size (a 2mm bore is sized at 1.9mm, a 4mm bore sized at 3.9mm) to give a firm, secure hold to the shaft.

MINIATURE PULLEY SET manufactured from high-impact polystyrene. 6 sizes:- 8mm, 10mm, 12mm, 18mm, 25mm and 30mm diameter, each has a 2mm push-fit bore. Supplied in packs of 5 of the same size. or a pack of 12 containing 3 each of:- 8, 12, 18 & 25mm sizes.



CODE	TYPE	PRICE
GSMP07	Miniature Pulley 8mm dia 5 Pack.....	£1.00
GSMP11	Miniature Pulley 10mm dia 5 Pack.....	£1.15
GSMP12	Miniature Pulley 12mm dia 5 Pack.....	£1.40
GSMP18	Miniature Pulley 18mm dia 5 Pack.....	£1.60
GSMP25	Miniature Pulley 25mm dia 5 Pack.....	£1.89
GSMP30	Miniature Pulley 30mm dia 5 Pack.....	£1.99
GSMP10	Miniature Pulley Set 12 Pieces.....	£3.99

PULLEYS a range of high quality push fit nylon pulleys featuring 4mm bores. Available in a range of diameters allowing a range of ratios to be obtained. All types supplied individually.



CODE	TYPE	PRICE
570-400	Pulley 10mm Dia 4mm Bore SINGLE.....	£0.45
570-410	Pulley 12mm Dia 4mm Bore SINGLE.....	£0.45
570-430	Pulley 20mm Dia 4mm Bore SINGLE.....	£0.49
570-440	Pulley 25mm Dia 4mm Bore SINGLE.....	£0.50
570-442	Pulley 30mm Dia 4mm Bore SINGLE.....	£0.55
570-444	Pulley 40mm Dia 4mm Bore SINGLE.....	£0.99
570-446	Pulley 60mm Dia 4mm Bore SINGLE.....	£1.00

REDUCERS 4mm to 2mm allows gears and pulleys with a 4mm bore to be used on 2mm shafts. Supplied in packs of 5.



CODE	TYPE	PRICE
570-760	Reducers 4mm to 2mm Pack of 5.....	£1.30

NYLON PULLEY BLOCKS small pulley blocks suitable for education and prototyping. The pulley wheels are free running with a swivel hook at each end. Available with a single, double and triple wheel.

Pulley diameter - 40mm
Length inc hooks - 105mm
Width - 30mm.



CODE	TYPE	PRICE
NPB090	Nylon Pulley Block Single Wheel.....	£3.79
NPB091	Nylon Pulley Block Double Wheel.....	£3.99
NPB092	Nylon Pulley Block Triple Wheel.....	£4.39

BRASS MOTOR PULLEY a miniature brass pulley suitable for use with miniature motors with 2mm output shafts. Pulley diameter 7mm. Sold individually.



CODE	TYPE	PRICE
570-100	Brass Motor Pulley 7mm Dia 2mm Bore.....	£0.60

SQUIRES MODEL & CRAFT TOOLS

BRASS MOTOR PULLEY a miniature 10mm brass pulley with stand-off and grub screw fixing. Suitable for use with miniature motors with 3mm output shafts.



CODE	TYPE	PRICE
570-026	Brass Motor Pulley 10mm Dia 3mm Bore.....	£2.25

GEARS

MINIATURE GEARS a range of high quality gears ideal for modelling, robotics and prototyping. Supplied in packs of 5 of one type and a 45 piece set containing 9 different pieces, including:- 6 sizes of gears, 2 sizes of worms and 75mm steel shafts, 5 of each piece.

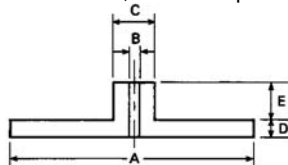

No Teeth		No Teeth		All dimensions in mm				
Outer dia	Inner dia	A	B	C	D	E		
16	-	9.0	1.9	-	5.0	-		
30	-	16.0	1.9	6.0	1.5	1.5		
42	-	22.0	1.9	6.0	1.5	2.5		
60	-	31.0	1.9	6.0	1.5	1.5		
30	10	16.0	1.9	5.5	1.5	2.5		
42	10	22.0	1.9	5.5	1.5	2.5		

Worm Gears:-Length 6mm & 10mm x 6mm diameter,
Steel Shafts:- Length 75mm x 2mm diameter.

CODE	TYPE	PRICE
GS0200	Gear 16 Teeth 9mm dia 5 Pack.....	£0.30
GS0205	Gear 30 Teeth 16mm dia 5 Pack.....	£0.40
GS0210	Gear 42 Teeth 22mm dia 5 Pack.....	£0.50
GS0215	Gear 60 Teeth 31mm dia 5 Pack.....	£0.75
GS0220	Gear 30/10 Teeth 16mm dia 5 Pack.....	£0.40
GS0225	Gear 42/10 Teeth 22mm dia 5 Pack.....	£0.50
GS0300	Worm 6mm 5 Pack.....	£0.40
GS0305	Worm 10mm 5 Pack.....	£0.45
GS4550	Miniature Gear Set 45 Pieces.....	£2.99

STEEL SHAFT a 75mm x 2mm diameter steel shaft for use with all 2mm push-fit gears and pulleys, in packs of 10.

CODE	TYPE	PRICE
GSSS60	Steel Shafts 75mm 10 Pack.....	£0.75

45° BEVEL GEARS a pair of 12mm nylon bevel gears, with a firm push-fit 2mm centre bore.



CODE	TYPE	PRICE
GSBG30	45° Bevel Gears 12mm Pair.....	£1.25

34:1 WORM AND GEAR a matched set of nylon worms and gears with a 2mm dia bore, allowing a tight push-fit to the shaft.



CODE	TYPE	PRICE
GSWG34	34:1 Worm and Gear.....	£1.20

**POST FREE DELIVERY ON ALL ORDERS
WITHIN THE UNITED KINGDOM
MINIMUM ORDER VALUE £15.00**

**You may mix your order from
ANY of our catalogues**

MODULE 1 GEARS

MODULE 1 GEARS a range of gears moulded from high quality nylon with coarse teeth. The gears have a 4mm bore moulded to 3.9mm for a tight push fit.

The range includes 7 gear sizes, bevel gears, worm gears and a rack. All supplied individually except the bevel gears which are supplied in pairs.

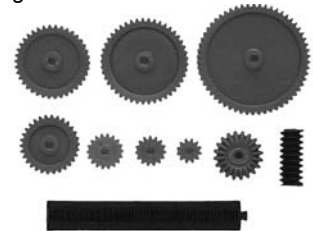

CODE	TYPE	Dia	PRICE
570-740	Module 1 Gear 12 Tooth SINGLE	14mm.....	£0.40
570-742	Module 1 Gear 15 Tooth SINGLE	17mm.....	£0.50
570-744	Module 1 Gear 18 Tooth SINGLE	20mm.....	£0.60
570-746	Module 1 Gear 30 Tooth SINGLE	31.5mm.....	£0.65
570-748	Module 1 Gear 38 Tooth SINGLE	39.5mm.....	£0.75
570-750	Module 1 Gear 45 Tooth SINGLE	46.5mm.....	£0.85
570-752	Module 1 Gear 58 Tooth SINGLE	59.5mm.....	£0.95
570-754	Module 1 Rack 100mm SINGLE.....		£0.75
570-758	Module 1 Worm Gears SINGLE.....		£0.90
570-756	Module 1 Bevel Gears PAIR.....		£1.85

REDUCERS 4mm to 2mm allows gears and pulleys with a 4mm bore to be used on 2mm shafts.

Supplied in packs of 5.



CODE	TYPE	PRICE
570-760	Reducers 4mm to 2mm Pack of 5.....	£1.30

CAMS

CAMS a range of polythene cams suitable for a wide range of repetitive motion uses. The range includes 2 pear-shape cams, 20/27mm and 29/40mm. A snail cam for 25/35mm and an eccentric cam of 25mm diameter. The thickness of the cams is 6mm. Suitable for use with 4mm shafts. Supplied in packs of 2.



CODE	TYPE	PRICE
570-700	Double Cam Small Pack of 2.....	£0.99
570-710	Double Cam Large Pack of 2.....	£0.99
570-720	Snail Cam Pack of 2.....	£0.99
570-730	Peg Cam Pack of 2.....	£0.99
PCS146	Steel Shaft 150mm (single).....	£0.50

OFF CENTRE MASS WHEELS These small mouldings fit directly onto 2mm motor spindles, providing imbalance that is required for vibrating mechanisms. Ideal for use in building vibrating 'bugs' and robotics. Obviate the need to apply any adhesive to ordinary wheels. **Motor not included.**



CODE	TYPE	PRICE
12-0008	Off-Centre Mass Wheel x1.....	£0.45

**PRODUCT CODES
PLEASE NOTE - IT IS VERY IMPORTANT
TO USE THE CORRECT PRODUCT CODE
FOR THE ITEMS YOU WISH TO ORDER**

SQUIRES MODEL & CRAFT TOOLS

CHAIN & SPROCKETS

PLASTIC CHAIN AND SPROCKETS miniature plastic chain and plastic sprocket set which is ideal for modelling, education and proto-typing. Supplied as a starter set containing the components to make 670mm of chain, one each of the 20 and 30 tooth sprockets, grub screws and hex key. The brass hubs have a 4mm bore, shafts are not included.

Extra chain and sprockets are available.
Sprocket diameter (across teeth):-
20 Tooth - 55mm
30 Tooth - 80mm
Note small sproket in image not supplied.

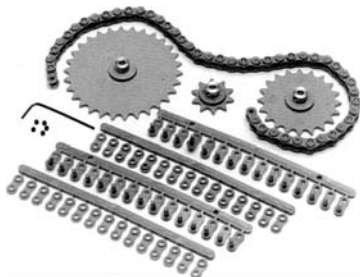

CODE	TYPE	PRICE
PCS150	Chain & Sprocket Starter Set.....	£9.99
PCS154	Sprocket 20 Tooth x1.....	£1.90
PCS156	Sprocket 30 Tooth x1.....	£1.99
PCS158	Chain Pack 180 Pieces for 670mm.....	£6.99
PCS146	Steel Shaft 150mm (single).....	£0.50

MINIATURE GEARBOX

MINIATURE GEARBOX a low cost gearbox designed for use with small motors such as 570-220/222/224 and similar small motors. The gearbox has a reduction of 42:1, the drive shaft is 4mm diameter. Ideal for modelling and robotics etc. **Motor not included.**

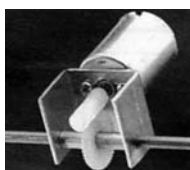

CODE	TYPE	PRICE
570-421	Economy Gearbox 42:1.....	£4.99

UNIVERSAL JOINT

SOFT-LINK TUBING a soft silicone polymer tubing which can be used as a flexible coupling in many low torque applications, such as flexible drive shafts, universal joints, linking push/pull rods, etc. Its softness and strength allows for an amount of compliance in otherwise rigid drive systems. Ideal for modelling and robotics applications where high torque and accuracy are not of paramount importance. Sold in lengths of 250mm.

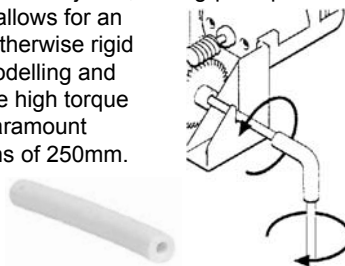

CODE	TYPE	PRICE
570-113	Soft Link Tubing 250mm Lengths.....	£1.00

WHEELS

ABS MODEL WHEELS a range of model wheels moulded in tough ABS. The wheels have a 2.6mm diameter bore. All sizes sold individually.



CODE	TYPE	PRICE
570-456	ABS Model Wheels 37 x 16mm Single.....	£0.79
570-457	ABS Model Wheels 44 x 16mm Single.....	£0.89
570-458	ABS Model Wheels 56 x 16mm Single.....	£1.40

PROPELLERS

PROPELLERS an essential resource for Design & Technology classroom, these propellers come in two different styles. Fits onto spindle 2mm diameter. 2 blade 120mm diameter. Sold individually.



CODE	TYPE	PRICE
12-0018	2 Blade Propeller.....	£0.89

MINIATURE IMPELLER a miniature impeller made from polystyrene and consists of 4 blades. 57mm diameter. Sold individually.

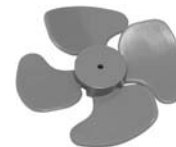

CODE	TYPE	PRICE
12-0022	Miniature 4 Blade Impeller.....	£2.09

POLYTHENE FAN a 60mm economy polythene fan demonstrates twistable blades. Fits tightly onto a 2mm diameter motor spindle. Sold individually.



CODE	TYPE	PRICE
12-0024	Polythene Fan 60mm.....	£0.55

PERFORATED STEEL SHEET

PERFORATED STEEL SHEET perforated steel sheet and strip to assist in the construction of models, robots etc. Strips 30cm x 0.8cm, sheets 20cm x 15cm. Sold individually.

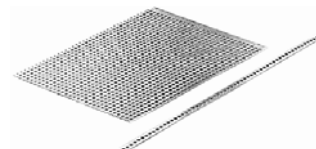

CODE	TYPE	PRICE
601-320	Perforated Steel Strip Single 30cm x 0.8cm.....	£1.85
601-325	Perforated Steel Sheet Single 20cm x 15cm.....	£4.99

**IF THER ARE OTHER
PRODUCTS THAT YOU WOULD
LIKE US TO STOCK
PLEASE FEEL FREE
TO LETS US KNOW**

**FREE PARKING FOR 2 HOURS
OUTSIDE OF OUR SHOP**

**SHOP OPEN
MONDAY - SATURDAY
9.00 - 5.30**

SQUIRES MODEL & CRAFT TOOLS

COOLING FANS

AXIAL COOLING FAN a low cost 40mm cooling fan offering low noise and high air flow. Frames and impellers are manufactured in black UL94V-0 glass filled polyester. Fitted with 300mm flying leads. UL and TUV approved.

Technical Specification

	5V DC	12V DC
Input current	0.11A	0.08A
Power	0.55W	0.96W
Speed (rpm)	4200	4200
Airflow (cu ft/min)	4.7	4.7
Noise dBA @ 1M	17.2	17.2
Operating temperature	-10 to +70 OC	



CODE	TYPE	PRICE
570-448	Cooling Fan 40mm 5V.....	£9.50
570-449	Cooling Fan 40mm 12V.....	£8.99
570-451	Metal Finger Guard 40mm.....	£1.00

AXIAL COOLING FAN a 60mm low voltage high speed cooling fan which may be mounted for either blow or extract function. The fan is fitted with a sleeve bearing (life expectancy of bearing >50,000 hours). The frame and impeller is manufactured in black glass filled polyester. Fitted with flying leads, finger guards are available.

Specification

	12V dc	24Vdc
Input current.....	0.23A	0.15A
Input power.....	2.8W	3.6W
Speed rpm.....	4500	
Airflow (cfm).....	23.2	
Noise level @1M.....	32.3dB	



CODE	TYPE	PRICE
CF0745	Cooling Fan 12V 60mm.....	£9.99
570-000	Cooling Fan 24V 60mm.....	£10.99
CFG820	Metal Finger Guard 60mm.....	£1.25

AXIAL COOLING FAN an 80mm low voltage high speed cooling fan which may be mounted for either blow or extract function. The fan is fitted with a sleeve bearing (life expectancy of bearing >50,000 hours). The frame and impeller are manufactured in black glass filled polyester. Fitted with flying leads. Finger guards are available.

Specification

	12V dc	24Vdc
Input current.....	0.25A	0.16A
Input power.....	3W	3.8W
Speed.....	3010	
Airflow (cfm).....	38.6	
Noise level @1M.....	34.4dB	



CODE	TYPE	PRICE
CF0765	Cooling Fan 12V 80mm.....	£10.99
570-005	Cooling Fan 24V 80mm.....	£12.99
CFG825	Metal Finger Guard 80mm.....	£1.65

AXIAL COOLING FAN a 120mm low voltage DC medium speed axial fan fitted with sleeve bearings (life expectancy > 50,000 hours). Frames and impellers are manufactured in UL94V-0 glass filled polyester. Fitted with 280mm flying leads. UL, CSA and TUV approved.

Specification

	12V dc	24Vdc
Input current.....	0.25A	0.16A
Input power.....	3W	3.8W
Speed.....	3010	
Airflow (cfm).....	38.6	
Noise level @1M.....	34.4dB	



CODE	TYPE	PRICE
570-450	Cooling Fan 12V 120mm.....	£19.99
570-452	Finger Guard 120mm.....	£1.99

120MM MAINS AXIAL FAN a high speed, aluminium-alloy framed, mains voltage AC fan fitted with copper sleeve bearings. The impeller is manufactured in glass-filled polyester. Connection is via 280mm flying leads.

Technical Specification

Nominal voltage.....	230V, 50Hz
Input current.....	0.12A
Input power.....	16.0W
Speed.....	2,600 rpm
Air flow.....	83.0 cu ft/min
Noise level.....	42.2dBA
Dimensions.....	120x120x38.5mm
Fixing centres.....	105x105mm
Mounting holes.....	4x4.3mm dia
Weight.....	530g



CODE	TYPE	PRICE
570-207	Mains Axial Fan 230V AC.....	£20.59

FAN GUARDS

ABS FAN GUARDS fan guards moulded in UL-94V-0. Hi-impact ABS. Guards have 4 countersunk mounting holes. Designed for low air noise.

Available to fit fan sizes as listed.

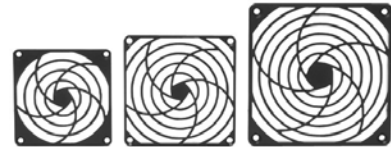

CODE	TYPE	PRICE
12-0010	ABS Fan Guard 40mm.....	£1.89
12-0012	ABS Fan Guard 60mm.....	£2.07
12-0014	ABS Fan Guard 80mm.....	£2.29
12-0016	ABS Fan Guard 120mm.....	£2.99

ABS FAN FILTER ASSEMBLIES fan filter assemblies consisting of a guard, filter media and snap-fit retainer. Guard and retainer are moulded in UL 94V-0. High impact ABS. Guards have 4 countersunk mounting holes. Assemblies have been specially designed for minimal air resistance. Low noise and ease of filter changing. Re-useable polyurethane foam filters can simply be vacuumed or cleaned with detergent or cleaning solvents as required. Available to suit fan sizes listed.



CODE	TYPE	PRICE
12-0000	ABS Fan Filter Assembly 40mm.....	£1.79
12-0002	ABS Fan Filter Assembly 60mm.....	£1.99
12-0004	ABS Fan Filter Assembly 80mm.....	£2.19
12-0006	ABS Fan Filter Assembly 120mm.....	£2.70

PRODUCT CODES

PLEASE NOTE - IT IS VERY IMPORTANT TO USE THE CORRECT PRODUCT CODE FOR THE ITEMS YOU WISH TO ORDER

IT IS VITAL TO INCLUDE THE PUNCTUATION IN THE CODE AND TO FORMAT THE CODE AS SHOWN IN THE CATALOGUE